

FIRE HOSE REEL WITH SEMI-RIGID HOSE



PRODUCT DESCRIPTION

NAFFCO fire hose reels provide a very effective firefighting facility with a continuous supply of water available immediately. The construction and performance of a fire hose reel with semi-rigid hose ensures suitable installation in buildings and other construction works for use by the occupants. The fire hose reels are manufactured in both manual and automatic versions to comply to BS EN 671-1:2012 standard with semi-rigid hose complying with BSEN 694:2014 standards.

FEATURES

- BSI Kitemark and LPCB certified.
- Hose Reel Assembly compliance to CPR Directive 305/2011/EU is certified by BSI (0086)
- The fire hose reels are capable of rotating in one plane (fixed type) or rotating in more than one plane with mounting on one of the following: swinging arm, swinging pipe or swinging door in manual and automatic version.
- The automatic fire hose reels will open fully within 3 revolution of the reel.
- The nozzle have SHUT, JET and SPRAY control settings.
- The minimum flow rate of hose reels in JET and SPRAY setting is 41 l/min. at 0.6 MPa (6 bar) pressure and setting in chrome plated rotary nozzle is 53 LPM at 0.6 MPa (6 bar) pressure.
- The effective throw range of discharge at 0.2 MPa (2 bar) pressure is 10 meters in JET setting.
- The reel discs are painted RED with printed user instructions.

OPERATING INSTRUCTIONS

AUTOMATIC HOSE REELS

- Pull out the hose and then water flow will start within 3 rotations.
- Open nozzle, adjust to spray or jet as required.
- Aim nozzle at base of fire.
- After use, close the nozzle and rewind the hose, ensuring that it is properly wound around the hose reel (not overlapping side plates). Open the nozzle to drain water from the hose and then close the nozzle on completion.



MANUAL HOSE REELS

- Open the main valve fully.
- Pull out the hose.
- Open nozzle, adjust to spray or jet as required.
- Aim nozzle at base of fire.
- After use, close the nozzle, turn off the main valve, rewind the hose, ensuring that it is properly wound around the hose reel (not overlapping the side plates). Open the nozzle to drain water from the hose and then close the nozzle on completion.



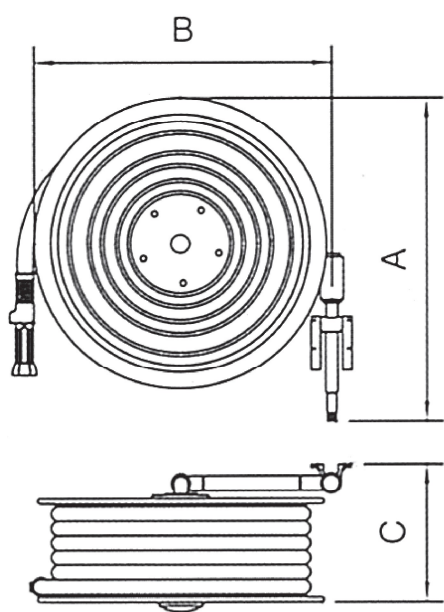

SWINGING PIPE TYPE

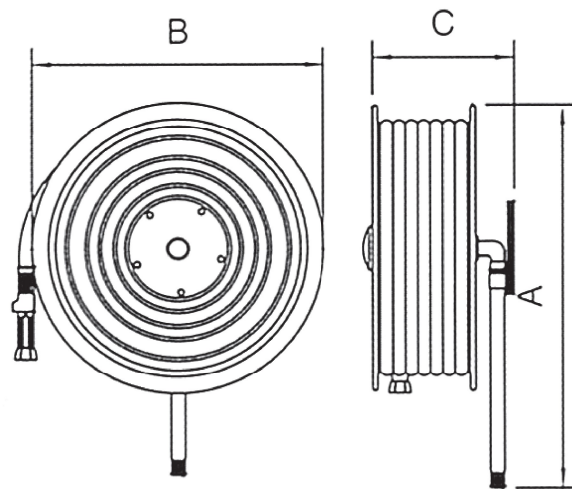

FIXED TYPE

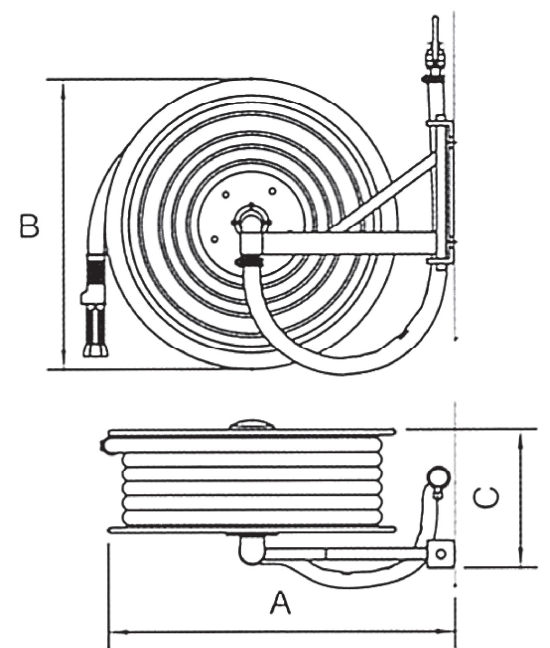

SWINGING ARM TYPE

FIRE HOSE REEL ASSEMBLY

Type	Model No.	Hose Diameter & Length	Reel Height (A in mm)	Reel Width (B in mm)	Reel Depth (C in mm)
Swinging Arm (Plastic Nozzle)	19 NFH-020M/SS	19 mm (¾") & 30 m	605	550	220
Cabinet Mounted Manual (Brush/Mirror Finish)	25 NFH-020M/SS	25 mm (1") & 30 m	605	550	245
Swinging Arm (Brass chrome plated rotary Nozzle)	19 NFH-020M/SS-B	19 mm (¾") & 30 m	605	550	220
Cabinet Mounted Manual (Brush/Mirror Finish)	25 NFH-020M/SS-B	25 mm (1") & 30 m	605	550	245
Swinging Arm (Plastic Nozzle)	19 NFH-020M	19 mm (¾") & 30 m	620	580	200
Cabinet Mounted Manual (Red Painted)	25 NFH-020M	25 mm (1") & 30 m	625	580	245
	25 NKFH-020M	25 mm (1") & 30 m	680	620	210
Swinging Arm (Brass Chrome Plated Rotary Nozzle)	19 NFH-020M-B	19 mm (¾") & 30 m	620	580	200
Cabinet Mounted Manual (Red Painted)	25 NFH-020M-B	25 mm (1") & 30 m	625	580	245
	25 NKFH-020M-B	25 mm (1") & 30 m	680	620	210
Swinging Arm (Plastic Nozzle)	19 NFH-020A/SS	19 mm (¾") & 30 m	605	550	220
Cabinet Mounted Automatic (Brush/Mirror Finish)	25 NFH-020A/SS	25 mm (1") & 30 m	605	550	265
Swinging Arm (Brass Chrome Plated Rotary Nozzle)	19 NFH-020A/SS-B	19 mm (¾") & 30 m	605	550	220
Cabinet Mounted Automatic (Brush/Mirror Finish)	25 NFH-020A/SS-B	25 mm (1") & 30 m	605	550	265
Swinging Arm (Plastic Nozzle)	19 NFH-020A	19 mm (¾") & 30 m	620	580	200
Cabinet Mounted Automatic (Red Painted)	25 NFH-020A	25 mm (1") & 30 m	625	580	245
	25 NKFH-020A	25 mm (1") & 30 m	680	620	210

Type	Model No.	Hose Diameter & Length	Reel Height (A in mm)	Reel Width (B in mm)	Reel Depth (C in mm)
Swinging Arm (Brass Chrome Plated Rotary Nozzle) Cabinet Mounted Automatic (Red Painted)	19 NFH-020A-B	19 mm (¾") & 30 m	620	580	190
	25 NFH-020A-B	25 mm (1") & 30 m	625	580	230
	25 NKFH-020A-B	25 mm (1") & 30 m	680	620	210
Swinging Pipe (Plastic Nozzle) Wall Mounted Manual (Brush/Mirror Finish)	19 NFH-030M/SS	19 mm (¾") & 30 m	580	550	220
	25 NFH-030M/SS	25 mm (1") & 30 m	580	550	265
Swinging Pipe (Brass Chrome Plated Rotary Nozzle) Wall Mounted Manual (Brush/Mirror Finish)	19 NFH-030M/SS-B	19 mm (¾") & 30 m	580	550	220
	25 NFH-030M/SS-B	25 mm (1") & 30 m	580	550	265
Swinging Pipe (Plastic Nozzle) Wall Mounted Manual (Red Painted)	19 NFH-030M	19 mm (¾") & 30 m	595	580	200
	25 NFH-030M	25 mm (1") & 30 m	595	580	240
Swinging Pipe (Brass Chrome Plated Rotary Nozzle) Wall Mounted Manual (Red Painted)	19 NFH-030M-B	19 mm (¾") & 30 m	595	580	200
	25 NFH-030M-B	25 mm (1") & 30 m	595	580	240
Swinging Pipe (Plastic Nozzle) Wall Mounted Automatic (Brush/Mirror Finish)	19 NFH-030A/SS	19 mm (¾") & 30 m	580	550	220
	25 NFH-030A/SS	25 mm (1") & 30 m	580	550	265
Swinging Pipe (Brass Chrome Plated Rotary Nozzle) Wall Mounted Automatic (Brush/Mirror Finish)	19 NFH-030A/SS-B	19 mm (¾") & 30 m	580	550	220
	25 NFH-030A/SS-B	25 mm (1") & 30 m	580	550	265
Swinging Pipe (Plastic Nozzle) Wall Mounted Automatic (Red Painted)	19 NFH-030A	19 mm (¾") & 30 m	595	580	200
	25 NFH-030A	25 mm (1") & 30 m	595	580	240
Swinging Pipe (Brass Chrome Plated Rotary Nozzle) Wall Mounted Automatic (Red Painted)	19 NFH-030A-B	19 mm (¾") & 30 m	595	580	200
	25 NFH-030A-B	25 mm (1") & 30 m	595	580	240
Manual (Plastic Nozzle) Fixed (Brush/Mirror Finish)	19 NFH-040M/SS	19 mm (¾") & 30 m	620	550	230
	25 NFH-040M/SS	25 mm (1") & 30 m	620	550	275
Manual (Brass Chrome Plated Rotary Nozzle) Fixed (Brush/Mirror Finish)	19 NFH-040M/SS-B	19 mm (¾") & 30 m	620	550	230
	25 NFH-040M/SS-B	25 mm (1") & 30m	620	550	275
Manual (Plastic Nozzle) Fixed (Red Painted)	19 NFH-040M	19 mm (¾") & 30 m	635	580	210
	25 NFH-040M	25 mm (1") & 30 m	635	580	255
Manual (Brass Chrome Plated Rotary Nozzle) Fixed (Red Painted)	19 NFH-040M-B	19 mm (¾") & 30m	635	580	210
	25 NFH-040M-B	25 mm (1") & 30 m	635	580	255

Type	Model No.	Hose Diameter & Length	Reel Height (A in mm)	Reel Width (B in mm)	Reel Depth (C in mm)
Automatic (Plastic Nozzle)	19 NFH-040A/SS	19 mm (¾") & 30 m	620	550	230
Fixed (Brush/Mirror Finish)	25 NFH-040A/SS	25 mm (1") & 30 m	620	550	275
Automatic (Brass Chrome Plated Rotary Nozzle)	19 NFH-040A/SS-B	19 mm (¾") & 30 m	620	550	230
Fixed (Brush/Mirror Finish)	25 NFH-040A/SS-B	25 mm (1") & 30 m	620	550	275
Automatic (Plastic Nozzle)	19 NFH-040A	19 mm (¾") & 30 m	635	580	210
Fixed (Red Painted)	25 NFH-040A	25 mm (1") & 30 m	635	580	255
Automatic (Brass Chrome Plated Rotary Nozzle)	19 NFH-040A-B	19 mm (¾") & 30 m	635	580	210
Fixed (Red Painted)	25 NFH-040A-B	25 mm (1") & 30 m	635	580	255

LOCK SHIELD VALVE

NAFFCO Lock Shield Valve is usually installed where unauthorized operation has to be avoided. A typical application of this valve is installing these at inlet pipe to the hose reel where it can be opened only by key and key kept by maintenance or fire safety department.



FEATURES

- Solid Wedge, non-rising stem, screwed in bonnet.
- Valves are manufactured in accordance to BS 5154 series B.
- Service temperature -10 to +66°C.
- Pressure rating is PN 20.
- End connection is BSPT threaded to BS21.
- Material: Brass

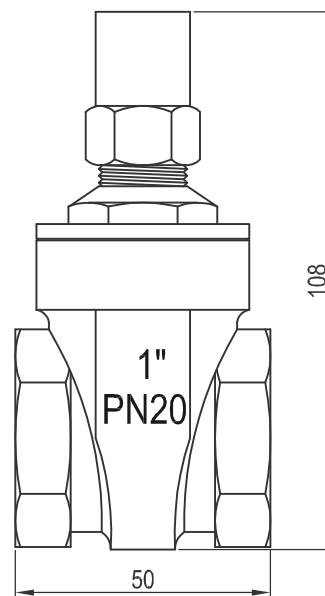
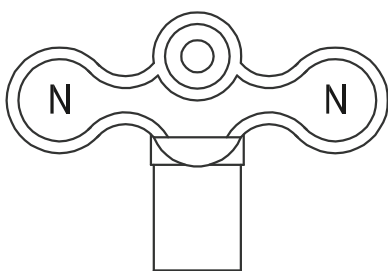

SPECIFICATION

Model Number	Size (in.)	Pressure Rating	Connecting
NLSV-25	1	PN 20	1" BSPT Female Threaded